

EXPLORATION COMMONS AT 50 EAST

July 13 and July 14, 10:00am-3:30pm

July 15 9:00am-12:30pm

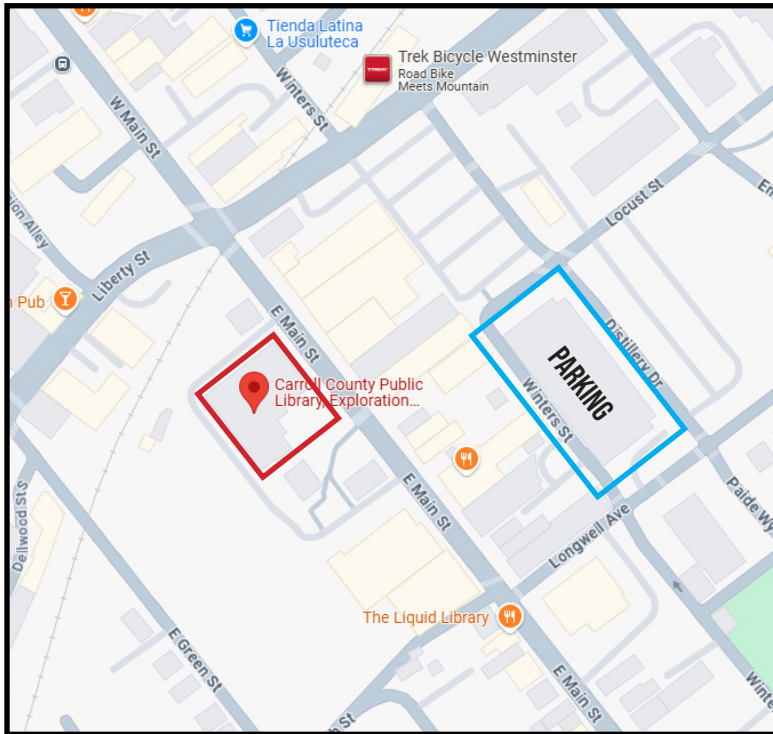

ADDRESS

50 East Main St.
Westminister, MD 21157
Ground Floor of Westminister Branch

PARKING

Longwell Parking Garage on
Winters Street

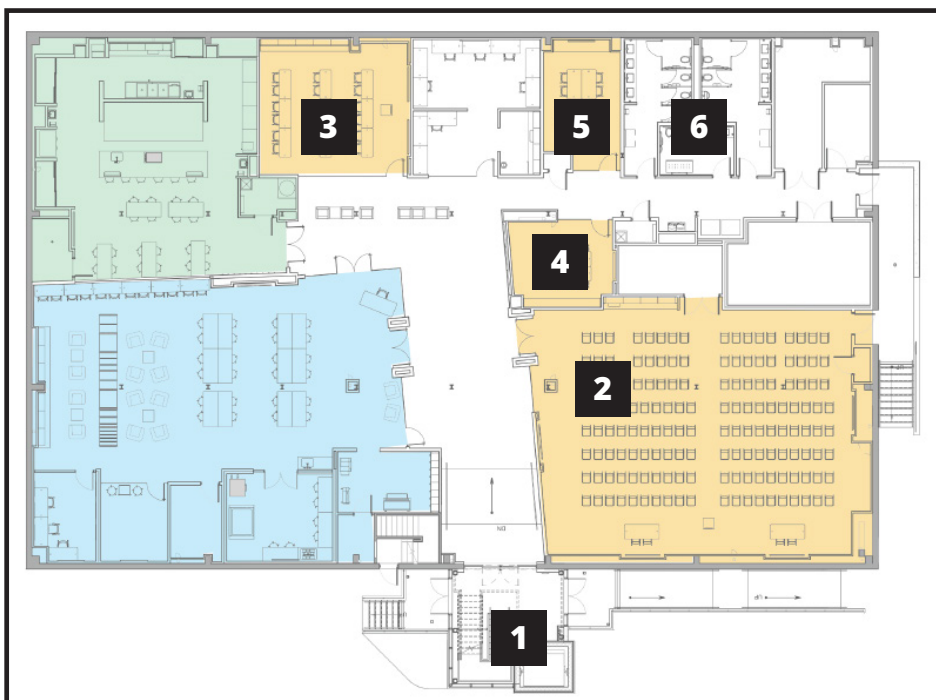

INTERIOR

- 1 - Stairs/Elevator
- 2 - Large Meeting Room
- 3 - Large Classroom
- 4 - Small Classroom A
- 5 - Small Classroom B
- 6 - Restrooms

COURTHOUSE

July 15, 1:30pm (Arrival time 1:00pm)

Students and spectators should **arrive at the courthouses at 1:00pm on 7/15** to allow for clearing security checks and getting situated.

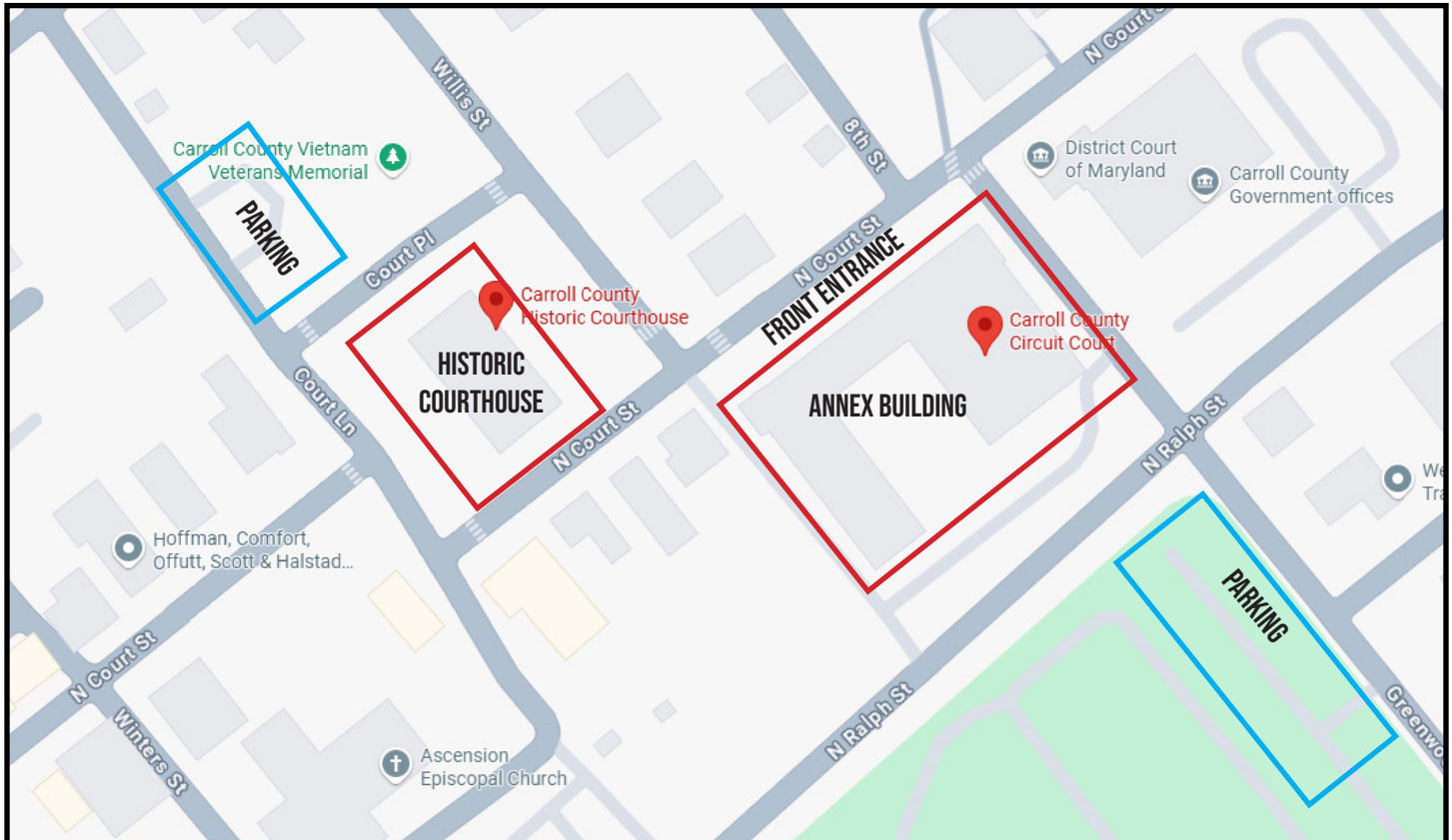

ADDRESS: HISTORIC COURTHOUSE
 200 Willis St.
 Westminster, MD 21157

ADDRESS: ANNEX BUILDING
 55 N Court St.
 Westminster, MD 21157

TEAM COURTROOM ASSIGNMENTS

Teams 1 and 6
 Historic Courthouse
 Courtroom #1

Teams 2 and 5
 Annex Building
 Courtroom #6

Teams 3 and 4
 Annex Building
 Courtroom #8